



MAKEUP LESSON: SUPERMATCH

The 11th grade *SuperMatch* Lesson is part of the High School and Beyond Plan, a WA state graduation requirement. The lesson was delivered in class. You were either absent or started attending this school after the lesson was delivered. Follow the instructions below to complete the activity.

COMPLETE THE ACTIVITY:

- 1) On the Naviance home page, click the **My Planner** section on the righthand side.
- 2) Click **Tasks**.
- 3) Under Tasks you Need to Work On, click **Complete SuperMatch College Search**.
- 4) Click **Search for Colleges**.

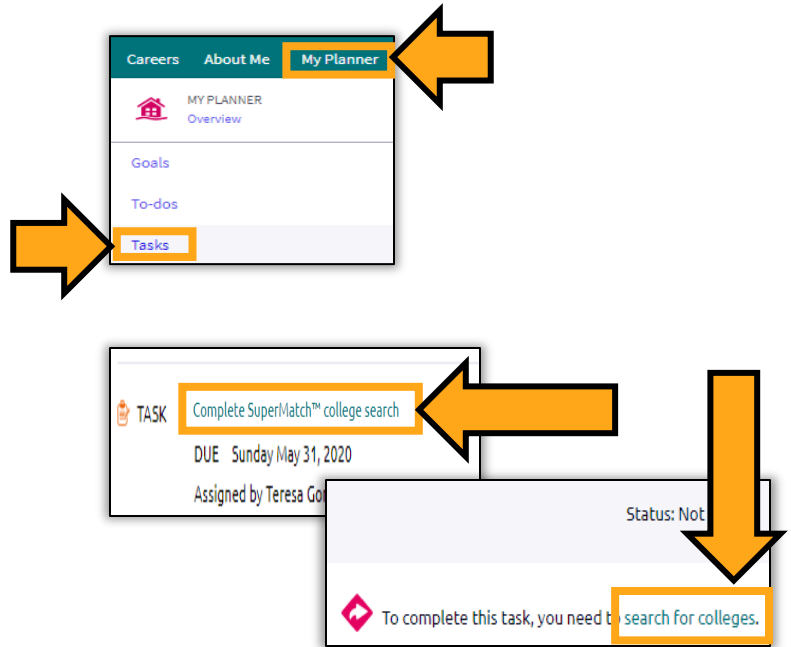

Use the criteria tabs to identify what is important to you. You can move criteria from must have to nice to have by clicking the arrows. This will widen your search.

- 5) Click **Favorite** next to the colleges that interest you the most.
- 6) Favorite **at least 2** colleges.

Favoriting colleges does not mean you have to apply to that college, just that it is interesting and meets your needs.

